



Model 60-2
Model 72-2
Model 84-2
Two Roller Pulverizers

Mathews Company / 500 Industrial Ave., Crystal Lake, IL 60012, U.S.A.
815/459-2210 FAX: 815/459-5889

Model 60-2
 Model 72-2
 Model 84-2

Two Roller Pulverizers

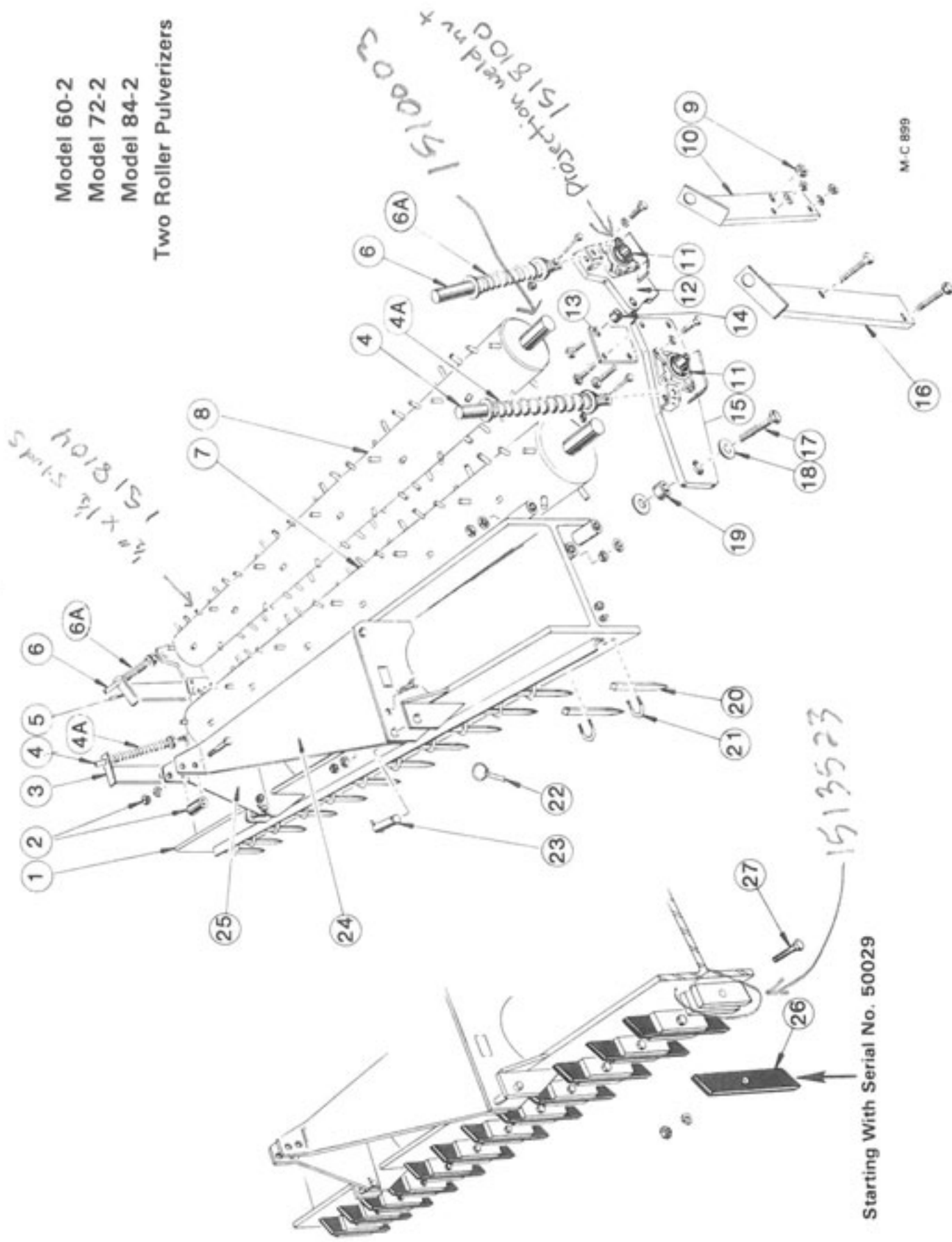

Starting With Serial No. 50029

M.C. 859

Ref.	Part No.	Qty.	Description	Ref.	Part No.	Qty.	Description	Ref.	Part No.	Qty.	Description
1	151 0015	1	I Beam	8	151 0016	1	Roller Tube - Small	18	000 8177	4	3/4" Flatwasher
	151 0002	1	60-2		151 0001	1	60-2 (85 Pins)	19	151 5601	2	Swing Arm Bushing
	151 0018	1	72-2		151 0019	1	72-2 (103 Pins)	20	151 8102	25	3/8" Square Spike Tooth (72-2 Only Below S/N 50029)
2	151 5600	1	84-2	9	091 8189	2	84-2 (121 Pins)	21	151 8101	25	7/16" "U" Anchor Bolt w/ nuts & washers (72-2 Only Below S/N 50029)
	001 8200	1	Hitch Spacer Cylinder	10	151 0007	1	3/8-11 Two Way Locknut				
		1	3/8-10 x 4" Capscrew - Grd. 5	11	151 6000	4	Rear Spring Tower - Left				
	000 8182	1	3/8" Lockwasher		001 8144	16	1" Bore Brg.-Triple Lip Seal				
	000 8165	1	3/8-10 Hex Nut				3/8-16 x 1 1/4" Capscrew - Grd. 5				
3	151 0006	1	Front Spring Tower - Right		001 8139	16	3/8" Lockwasher	22	000 8995	2	Klick Pin-5/16" OD
	001 8294	2	3/8-11 x 4 1/2" Capscrew - Grd. 5	12	151 0011	1	Rear Swing Arm - Left	23	151 5000	2	3/8" Connection Pin
	000 8181	2	3/8" Lockwasher		151 0012	1	Rear Swing Arm - Right		001 8292	2	1/4 x 2" Roll Pin
	000 8164	2	3/8-11 Hex Nut	13	151 3522	2	Link Plate	24	151 3521	2	Hitch Plate - Left
4	151 5022	2	Spring Rod - Front		001 8154	2	3/8-11 x 2 1/4" Capscrew - Grd. 5		128 8195	2	3/8-10 x 2" Capscrew - Grd. 5
	000 8276	4	1" SAE Flatwasher		001 8153	4	1/2-13 x 2 1/4" Carriage Bolt - Grd. 5		000 8182	2	3/4" Lockwasher
	001 8291	2	1-8 Hex Jam Nut		128 8164	4	1/2-13 Two Way Locknut		000 8165	2	3/8-10 Hex Nut
	001 8147	2	3/8-16 x 2 1/2" Capscrew - Grd. 5	14	151 5590	2	Swing Arm Pivot	25	151 3520	1	Hitch Plate - Right
	000 8162	2	3/8-16 Hex Nut				Brkt. Spacer		128 8195	2	3/8-10 x 2" Capscrew - Grd. 5
4A	151 8700	2	Front Swing Arm Spring (Free length - 12")	15	151 0009	1	Front Swing Arm - Left (Below S/N 50029)		000 8182	2	3/4" Lockwasher
	151 0008	1	Rear Spring Tower - Right		151 0013	1	Front Swing Arm - Left (Above S/N 50028)		000 8165	2	3/8-10 Hex Nut
	151 5021	2	Spring Rod Rear		151 0010	1	Front Swing Arm - Right (Below S/N 50029)	26	151 3575	-	Scarifying Tooth (Above S/N 50028)
	000 8276	4	1" SAE Flatwasher		151 0014	1	Front Swing Arm - Right (Above S/N 50028)			21	60-2
	001 8291	2	1-8 Hex Jam Nut	16	151 0005	1	Front Spring Tower - Left			25	72-2
	001 8147	2	3/8-16 x 2 1/2" Capscrew - Grd. 5		001 8294	2	3/8-11 x 4 1/2" Capscrew - Grd. 5			29	84-2
	000 8162	2	3/8-16 Hex Nut				3/8-10 x 4 1/2" Capscrew - Grd. 5	27	128 8166	-	1/2-13 x 2 1/2" Capscrew - Grd. 5
6A	151 8701	1	Rear Swing Arm Spring (Free length - 9 1/2")		000 8181	2	3/8" Lockwasher		000 8163	-	1/2-13 Hex Nut
		-	Roller Tube - Large	17	001 8182	2	3/8-11 Hex Nut		000 8180	-	1/2" Lockwasher
	151 0017	1	60-2 (85 Pins)		000 8164	2	3/8-10 x 4 1/2" Capscrew - Grd. 5			21	60-2
	151 0000	1	72-2 (103 Pins)		000 8182	2	3/4" Lockwasher			25	72-2
	151 0020	1	84-2 (121 Pins)		000 8165	2	3/8-10 Hex Nut			29	84-2